

*T. Weaver,*

*School Desk and Seat.*

*N<sup>o</sup> 45,286.*

*Patented Nov 29, 1864.*

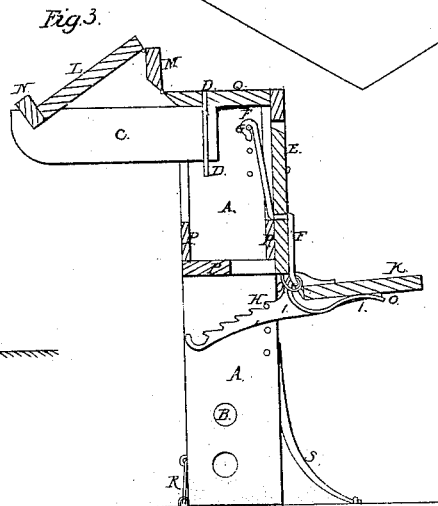
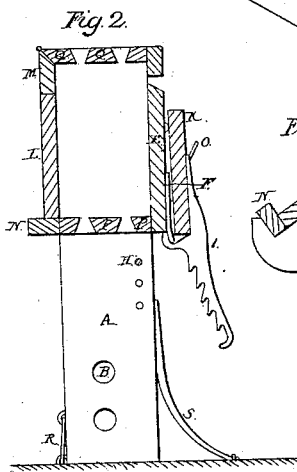
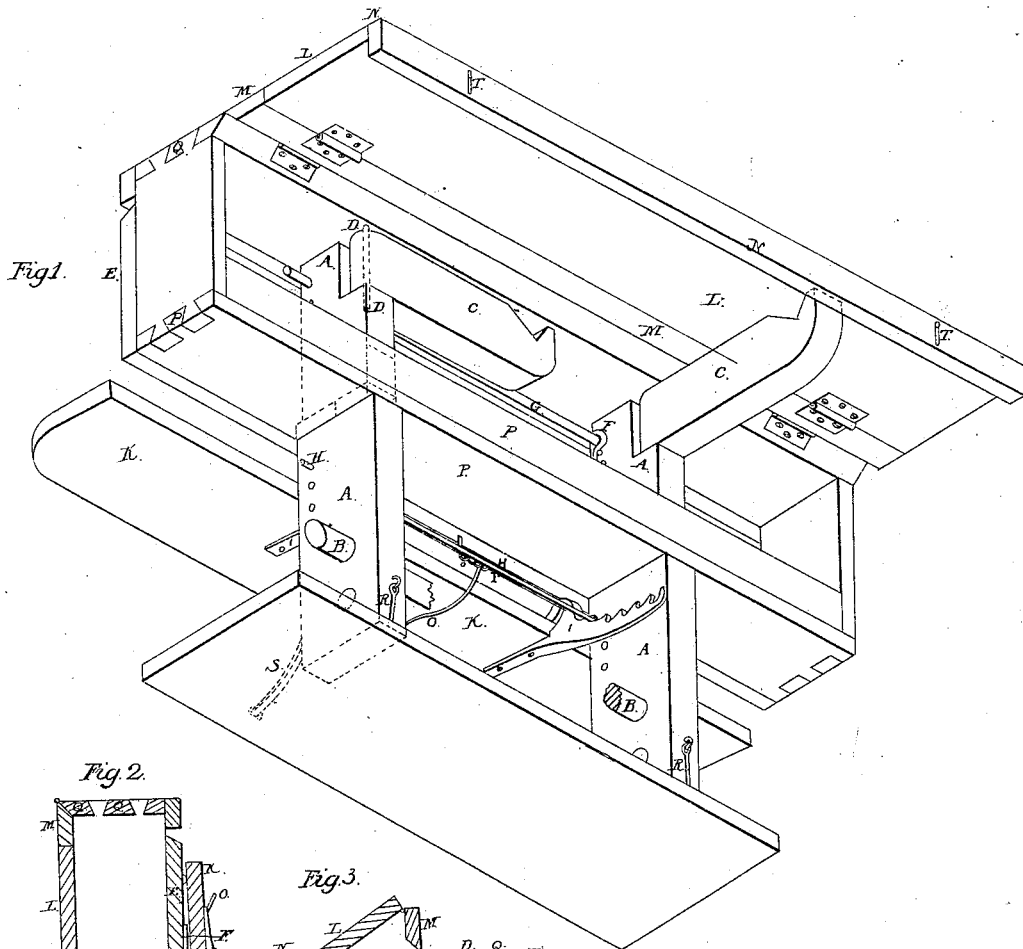

*Witnesses:*

*Wm Lloyd  
E S. Engle*

*Inventor:*

*Thos Weaver.*

# UNITED STATES PATENT OFFICE.

THEOS WEAVER, OF HARRISBURG, PENNSYLVANIA.

## IMPROVED SCHOOL TABLE AND SEAT.

Specification forming part of Letters Patent No. 45,286 dated November 29, 1864.

*To all whom it may concern:*

Be it known that I, THEOS WEAVER, of the city of Harrisburg, in the county of Dauphin and State of Pennsylvania, have made a new and useful Improvement on an Adjustable School Desk and Seat Combined; and I do hereby declare that the following is a full, clear, and exact description of the construction and operation of the same, reference being had to the annexed drawings, making a part of this specification, in which—

Figure 1 is a perspective view. Fig. 2 is an end view, and Fig. 3 is a transverse section.

I construct my desk on two or more standards, A A, which are penetrated by the foot-rest B at different heights. The standards are secured to the floor by the braces S S and the hooks R R entering staples on the floor. They are placed in from the ends of the desk, as shown in Fig. 1. They pass up through the body of the desk, and are dovetailed into the bottom board, forming, with two side boards, the book-case P P P, as shown in Fig. 3. Their upper extremities are surmounted by the top board, Q, which is connected with the bottom board, P, at the ends, as shown in Fig. 2. To the top board, Q, is attached the adjustable folding leaf L M in two sections, hinged together, the outer section, L, supporting the ledge N, which is secured to it by screws through the slots T T, as shown in Fig. 1. Beneath the leaf and top are two notched folding braces, C C, inserted into the standards, as shown in Fig. 1. Their axes D D pass through the top Q. On the opposite side of the standards is the adjustable rod G with its several graded holes in the standards. To this rod is hooked, near the standards, the diverted rod F, which passes through the sliding back board, E, thereby regulating it. The diverted rod then passes through the holes of the hooked, curved, and bracing ratchets I I, thereby holding and poising the seat-board K in position by means of another adjustable rod, H, on which the teeth of the ratchets act.

The operations of the leaf are, first, to form a plain writing-table, as shown in Fig. 1, by extending the sections L and M horizontally on the opened braces C C, permitting the ledge N to drop level with the upper surface, the screws in the slots T T then arresting and holding it; second, to form the inclined

reading-desk as shown in Fig. 3 by elevating section M and one side of section L, the other side dropping into the notches of the braces C C, thereby lifting the ledge N above the upper surface of L, thus forming a book-stop; third, to fold the leaf against the standards by folding the braces between them, as shown in Fig. 2.

The operations of the back E and seat K are, first, to form the erect seat (shown in Fig. 3) with the ratchets I I in place under the adjustable rod H, the seat-board poised and held in place by the diverted rod F, which also holds the back suspended on the rod G; second, to form a variously inclined seat by throwing the ratchets forward, their teeth holding the seat in position when pressed upon, the ratchets I I being arrested by their hooks against the rod H to prevent further extension; third, to form a high or low seat of any inclination by adjusting the rods G and H as shown in Fig. 3; fourth, to fold the seat by the automatic spring O, which is inserted into the lower edge of the back and coiled around and held in place by the rod F, as shown in Figs. 1 and 2, the foot-rest B being adjustable in all positions of the seat; fifth, the hooks R R and the braces S S are employed to fasten the desk by hooking in staples on floor, or to disengage the desk by unhooking.

I claim—

1. The standards A A, the foot-rest B, which penetrates them at various heights from the floor, the book-case P P P, combined and arranged substantially as and for the purposes herein described.

2. The combination and arrangement of the adjustable folding leaf L M, the ledge N, its slots T T, the notched braces C C, their axis D D, operating substantially in the manner as and for the purposes herein set forth.

3. The combination and arrangement of the adjustable rods G and H, the diverted rod F, the sliding back E, the seat K, the ratchets I I, the automatic spring O, supported by its coils around F, and its insertion into the back E, operating substantially in the manner as and for the purposes herein shown and described.

THEOS WEAVER.

Witnesses:

ISAAC LLOYD,  
E. S. ENGLES.