

S. Ustick,

Invalid Bedstead,

N^o 48,854.

Patented July 18, 1865.

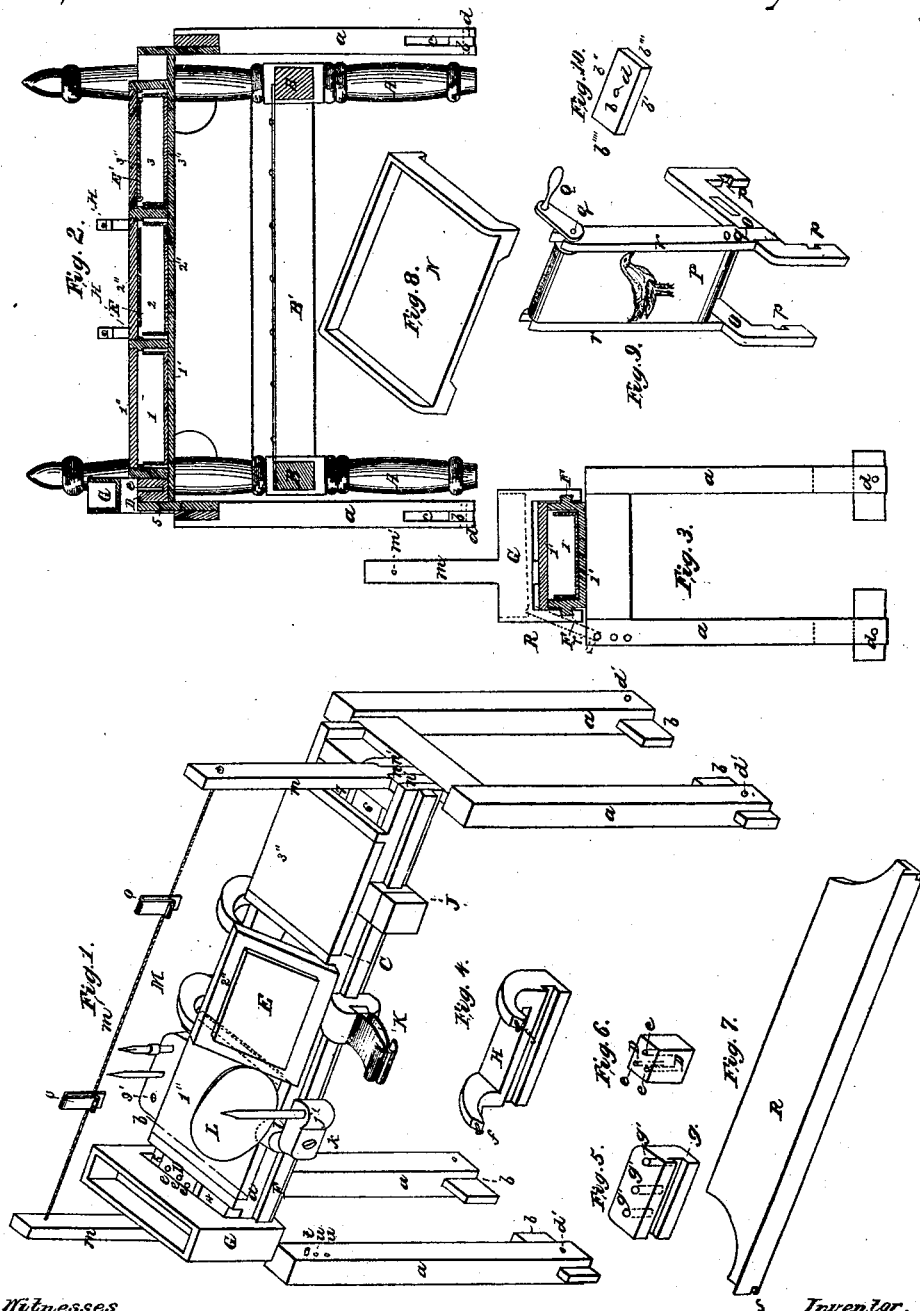

Witnesses.

David Eldridge
Sam H. Schumbold.

Inventor.
Stephen Wick.

UNITED STATES PATENT OFFICE.

STEPHEN USTICK, OF PHILADELPHIA, PENNSYLVANIA.

TABLE FOR INVALIDS.

Specification forming part of Letters Patent No. 48,854, dated July 18, 1865.

To all whom it may concern:

Be it known that I, STEPHEN USTICK, of the city and county of Philadelphia, and State of Pennsylvania, have invented a new and useful Table Apparatus for Invalids; and I do hereby declare that the following is a full, clear, and exact description of the construction and operation of the same, reference being had to the annexed drawings, making a part of this specification, in which—

Figure 1 is a perspective view of the table C and parts attached to the same. Fig. 2 is a vertical longitudinal section of the table in connection with a bedstead. Fig. 3 is a vertical cross-section of the table at the red line *a b* of Fig. 1. Fig. 4 is a perspective view of the movable rest H. Fig. 5 is a perspective view of the pen-rack I. Fig. 6 is a perspective view of the match-safe D. Fig. 7 is a perspective view of the book-rest R. Fig. 8 is a perspective view of the wash-bowl board N. Fig. 9 is a perspective view of the show-frame O and apron P. Fig. 10 is a perspective view of one of the adjustable foot-pieces *b*.

Like letters in all the figures represent the same parts.

The nature of my invention consists of a portable table apparatus for invalid bedsteads, adapted to various uses, recreations, and amusements of adults and children while in bed.

To enable others skilled in the art to make and use my invention, I will proceed to describe its construction and operation.

A A represent the foot-posts, and B B the side rails, of a bedstead.

C is a portable table, which, when in use, is placed transversely with the bedstead, and at a convenient distance from the head of the same. At other times it may be moved to the foot or entirely from it. The table and several devices which are used in connection with it are represented in Fig. 1. Other devices are shown in the other figures. The height of the table is graduated to suit different sizes of persons by means of the adjustable foot-pieces *b* in the mortises *c* of the legs *a*, there being holes *d* in the foot-pieces, as seen in Fig. 10, which fit on the pins *d'* which pass through the mortises, the holes *d* varying in distance from the edges *b'*, *b''*, *b'''*, and *b''''* for that purpose. There may also be a plurality of holes at dif-

ferent heights in the legs *a* for the accomplishment of the same end.

For ordinary use the top of the table may be in a single piece, but to make it subserve all the uses for which I design it I usually construct it with several principal compartments, 1 2 3, which occupy the greater portion of its length, and minor compartments 4, 5, 6, and 7 at the ends, the former containing cases 1', 2', and 3'—being ladies' work, writing, and dressing cases—of equal dimensions, so as to be susceptible of transposition when required. These compartments have covers 1'', 2'', and 3''. The compartments 4, 5, 6, and 7 may be used severally for holding an inkstand, lamp, &c. In one of these compartments there is a match-safe, D, which may be placed in either, as convenience may require. I usually construct the safe of a block of wood, with a few holes, *e*, each only large enough to hold a single match, to prevent accidents. On the under side of the cover 2'' I confine a writing-pad or portfolio, E, and in like manner a looking-glass, E', on 3'', each of which is reversed and held in position in the manner I will hereinafter describe.

For the purposes I will presently specify I construct the sides of the table C with longitudinal guides or ways F F, of any suitable form, although I prefer the dovetail form as represented in the drawings. The several devices which are combined with the said ways have corresponding female dovetails, and are movable by means thereof to any part of the table, as occasion may require, or they may be removed therefrom.

G is a sliding box connected in that manner with the table for the reception of such things as it might be unsafe to set flat on the same.

H is a movable rest to support the reversible covers 2'' and 3'', when desired to be placed on an angle. It has adjusting-screws *ff* for varying the angle of the covers. The cover 2'' is represented in its reversed and angular position for writing in Fig. 1, the lower front corner resting in a V-groove in the top of the front rail of the table-frame.

I is a pen-rack, which has a dovetail groove, *g*, as seen in Fig. 5, that fits on one of the ways F, and vertical holes *g'* for holding pens and pencils.

J is a pin-cushion on the dovetailed block *h* connected with the front guide-strip F.

K is a small vise or pair of clamps for holding any light article to be worked.

L is a screen, whose stem *i* turns in a hole in the swivel-block *j*, which is connected by means of the screw *k* with the dovetailed block *l* on the said guide-strip. The screen thus constructed and arranged may, as will readily appear, be placed at any part of the table required, or at any suitable height to screen the eyes of the patient who may be lying down or sitting up in bed.

M is a rack for holding a newspaper or other article to be read. It is formed of the uprights *m m*, and one or more cords, *m'*. The uprights *m* have dovetails *n* on their lower ends, which have an easy fit between corresponding strips, *n'*, on the end rails of the table, so that the said uprights may be removed when required. Rigid bars or rods may be used instead of the cords. There are clamps *o o* for holding the upper edge of the paper securely to the cord *m'*.

N is a board, which is placed on the table when required to hold washing apparatus.

For the purpose of presenting pleasing pictures to small children, I construct the frame *o*, which is connected to the ways F F by means of the female dovetails, as seen in Fig. 9, there being an endless apron, P, on rollers whose journals *q* turn in the uprights *r r*. Attached to one end of the shaft of the upper roller there is a crank, Q, for giving motion to the apron.

If desired, the roller may be actuated by means of a weight or spring, so as to keep the apron in motion a considerable length of time without an attendant. I print the pictures on the apron, or else attach them in any convenient manner, so that they may be removed to make place for other pictures. The device may at times when not required on the table C be used on an ordinary table.

There is a book-support, R, (represented in Fig. 7 and shown by red lines in Fig. 3,) which is placed at any desirable angle, with its flat surface at the top edge resting against the front corner of the table C, the openings *s s* in its lower edge resting on the pins *t*, which are adjustable to different heights by means of the holes *u* in the front legs of the table, which, as represented in the drawings, project out from the frame for that purpose.

Having thus fully described the construction and operation of my table and apparatus for invalids, what I claim therein as new, and desire to secure by Letters Patent, is—

1. The combination of the foot-pieces *b* with the legs *a* of the table C, when constructed, arranged, and operating substantially as described.

2. Combining and arranging the cord *m'* and clamps *o o* with the table C by means of the uprights *m m*, substantially as and for the purpose set forth.

3. Combining the longitudinal guides or ways F F with the table C, substantially in the manner and for the purposes above described.

4. The combination and arrangement of the box G, rest H, pen-rack I, pin-cushion J, clamps K, and screen L with the table C by means of the longitudinal guides or ways F F, substantially in the manner described, and for the purposes specified.

5. Combining and arranging the endless apron P with the table C by means of the frame O and guides F F, substantially as and for the purpose specified.

In testimony that the above is my invention I have hereunto set my hand and affixed my seal this 22d day of March, 1865.

STEPHEN USTICK. [L. S.]

Witnesses:

WM. H. HELMBOLD,
JAMES McCANON.