

WATSON SANFORD.

Improvement in Fire Place Ranges.

No. 115,644.

Patented June 6, 1871.

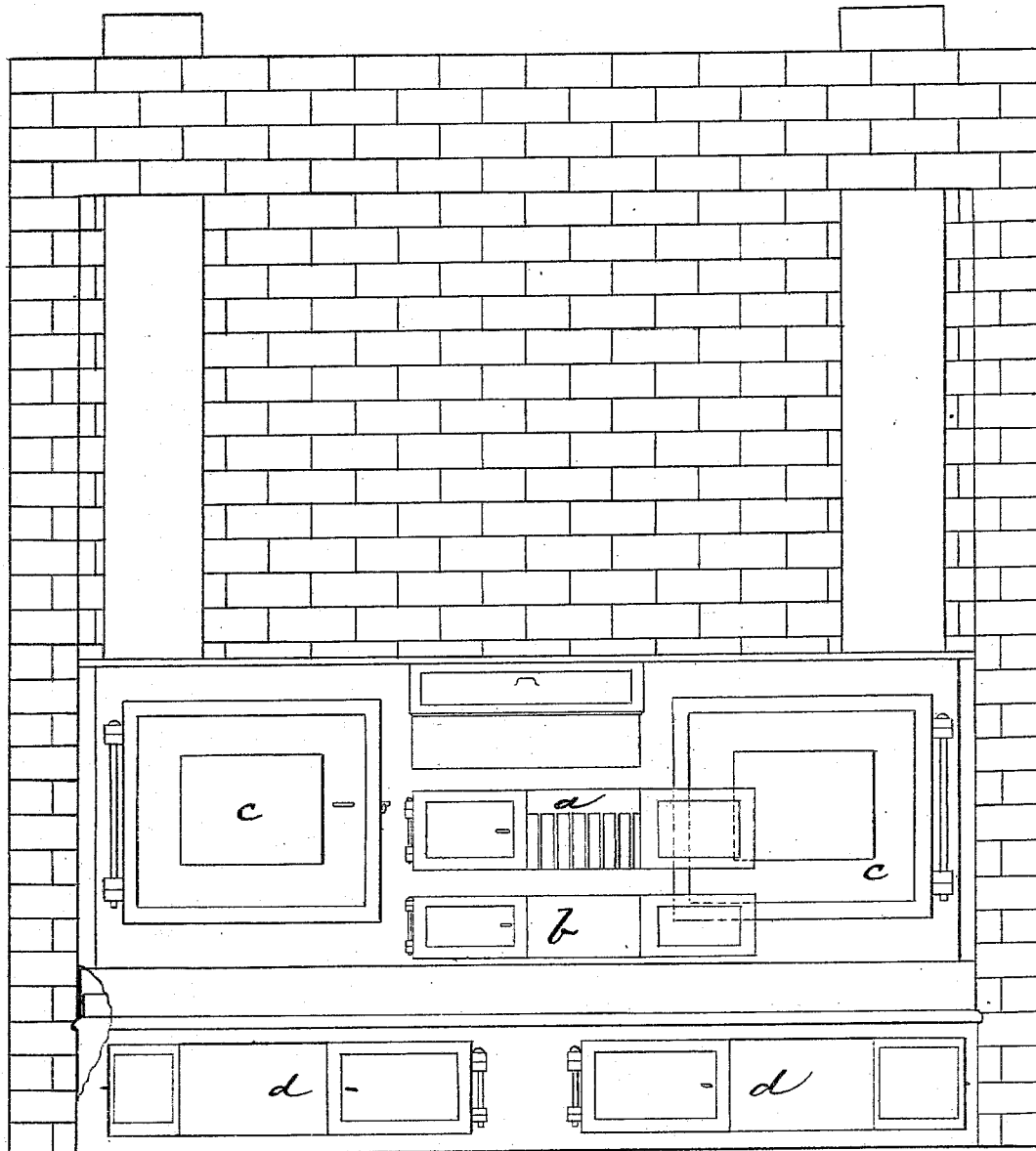

Witness  
A. M. Maccombs  
James H. Hunter

Inventor

Watson, Sanford

## UNITED STATES PATENT OFFICE.

WATSON SANFORD, OF BROOKLYN, NEW YORK.

## IMPROVEMENT IN FIRE-PLACE RANGES.

Specification forming part of Letters Patent No. 115,644 dated June 6, 1871.

*To all whom it may concern:*

Be it known that I, WATSON SANFORD, of the city of Brooklyn, county of Kings and State of New York, have invented a new and useful Improvement in Fire-Place Ranges; and I do hereby declare that the following is a clear and exact description of the same.

My improvement consists in the application, to a fire-place range, of a warming-closet, said closet being arranged beneath the base of the range.

In the accompanying drawing, *a* is the fire-place; *b*, the ash-pit; *c c*, the ovens for roasting or baking; and *d*, a closet for holding cooked food, dishes, &c., situated directly beneath the ovens, flues thereof, and ash-pit. This arrangement and location of warming-closet are superior to any other by reason of the heat being equalized therein by the joint action or effect of the flues of the main ovens

and the ash-pit. The cooked food, dishes, &c., desired to be kept warm can be very conveniently run into or out of such closet by reason of its forming the base of the range and being on a level with the hearth. The range is also, by such arrangement of warming-closet, elevated, and thereby rendered more convenient for cooking and baking operations.

This warming-closet may, if desired, be made in more than one compartment, and extend, more or less, beneath the base of the range.

What I claim as new is—

A warming-closet in a fire-place range, when said closet is arranged directly beneath the baking-ovens, flues, and ash-pit, and at the base of the range, substantially as described.

WATSON SANFORD.

Witnesses:

A. B. MALCOMSON, JR.,  
JAMES H. HUNTER.