

H. D. STANLEY.
Holder for Lamp-Shades.

No. 216,905.

Patented June 24, 1879.

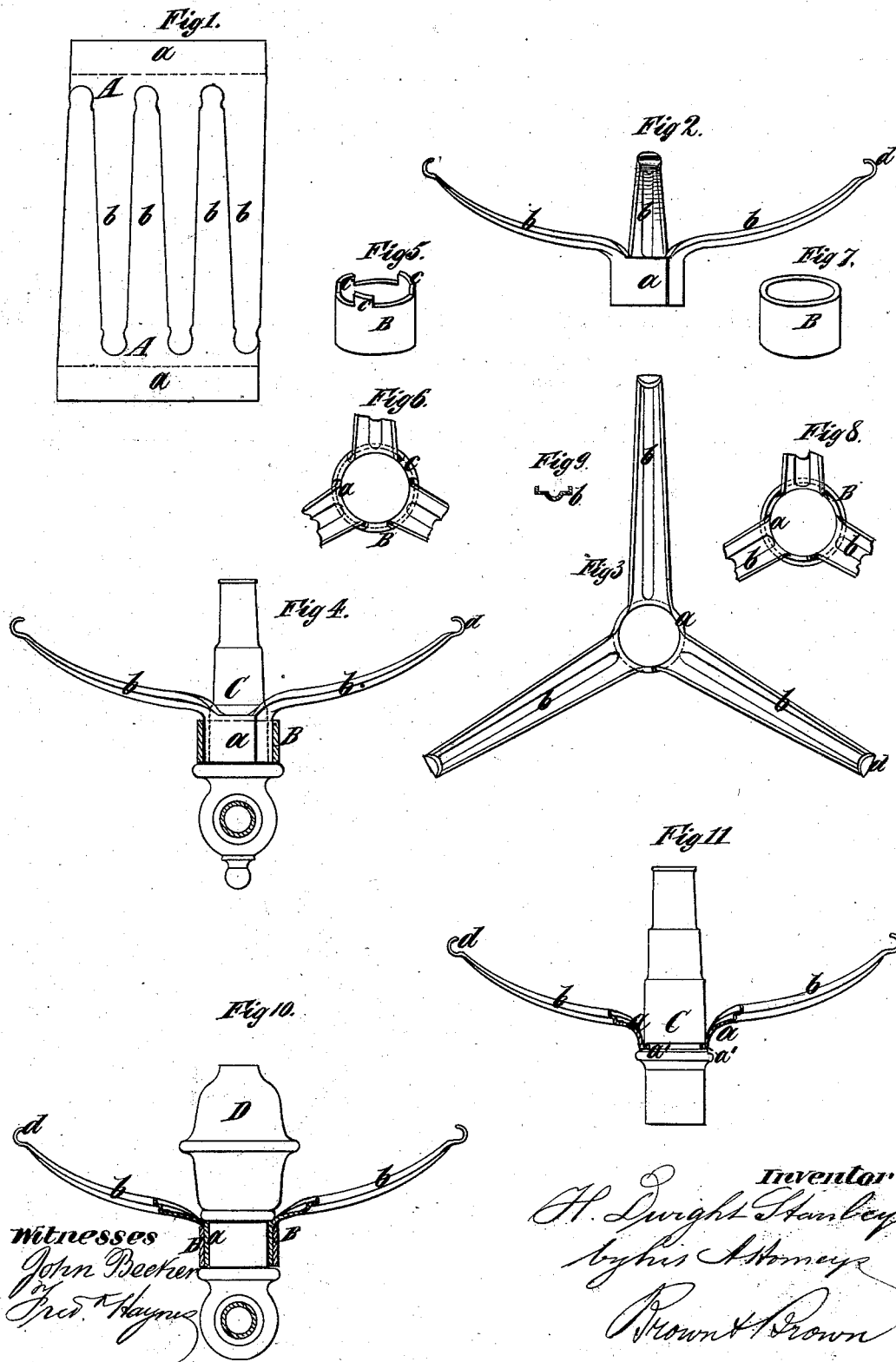

Witnesses

John Becker

Geo. H. Hays

Inventor

H. Dwight Stanley
by his Attorneys
Brown & Brown

UNITED STATES PATENT OFFICE.

H. DWIGHT STANLEY, OF BRIDGEPORT, CONNECTICUT.

IMPROVEMENT IN HOLDERS FOR LAMP-SHADES.

Specification forming part of Letters Patent No. **216,905**, dated June 24, 1879; application filed April 4, 1879.

To all whom it may concern:

Be it known that I, H. DWIGHT STANLEY, of Bridgeport, in the county of Fairfield and State of Connecticut, have invented certain new and useful Improvements in Holders for Lamp and Gas Globes and Shades, of which the following is a description.

In holders for globes and shades heretofore used the arms have generally been made of wire, separate from the band or collar of the holder, and secured thereto in various ways.

This invention consists in a holder for a globe or shade composed of a strip or body of sheet metal bent so as to form a band or collar and arms extending from one side thereof and bent so as to extend radially from said band or collar, said arms being corrugated longitudinally, for the purpose of increasing their strength, and bent at the ends so as to form claws for properly holding a globe or shade.

It also consists in the combination, with such a holder, of a re-enforcing ring or ferrule fitting over the said band or collar, serving to secure the same in its cylindrical shape and strengthen it.

In the accompanying drawings, Figure 1 represents a blank of sheet metal from which two shade-holders may be cut and formed. Fig. 2 is a side view of a completed holder. Fig. 3 is a plan thereof. Fig. 4 is a side view of a gas-burner, a holder mounted thereon, and a sectional view of its re-enforcing ring or ferrule. Fig. 5 is a perspective view of the re-enforcing ring or ferrule; Fig. 6, a plan of the band or collar of the holder and such re-enforcing ring. Fig. 7 is a perspective view of a ring or ferrule of modified form; Fig. 8, a plan of the band or collar of the holder and such re-enforcing ring. Fig. 9 is a transverse section through one of the arms. Fig. 10 is a side view of a bulb gas-burner and a sectional view of a holder of slightly modified form, and Fig. 11 is a side view of a pillar gas-burner and a sectional view of another holder of slightly modified form.

Similar letters of reference designate corresponding parts in all the figures.

Although here represented as applied to a gas-burner, the holder may be made of suitable size to be used upon lamps, the band or

collar of the holder being sufficiently large to fit upon the collar or other part of the lamp-burner.

Fig. 1 represents a piece of sheet metal from which two blanks, A A, may be cut. Each of these blanks consists of a body, *a*, and arms *b*, extending from such body. As here represented the arms of each blank are formed from metal so taken from between and outside of the arms of the other blank that the blanks are or may be cut without any waste of metal. The blank may, however, be modified in form.

After being cut out the body *a* of the blank is bent into a cylindrical form of the proper size to fit upon a gas-burner, as represented in Figs. 2 and 3, or of a size to fit upon the collar or other part of a lamp-burner if the holder is intended for use upon a lamp, and the arms are bent so as to extend radially from the band or collar *a*. The meeting ends of the body *a* may be united in any suitable manner, by dovetailing, or interlocking and soldering, or by soldering alone. I may, however, advantageously employ a re-enforcing ring or ferrule, B, fitting upon the outside of the band or collar *a*, and serving to hold it in its cylindrical shape. This ring or ferrule B may fit tightly over the band or collar *a*, and be secured by soldering thereto, or it may be provided upon its upper edge with ears or lugs *c*, adapted to be bent over the upper edge of the band or collar *a* and thereby secured upon it.

The arms *b* may advantageously be corrugated lengthwise, as clearly represented in Fig. 9, for the purpose of increasing their strength, and they are represented as bent at their outer ends to form claws *d* for holding a shade; or, if desirable, a shade-ring may be secured to their outer ends.

The band or collar *a* may fit snugly around the pillar C of a gas-burner, as represented in Fig. 4, and in such case it can be readily raised and removed from the burner. If desirable, however, the band or collar *a* may be of proper length to fit the body of a burner below the bulb D, as represented in Fig. 10, in which case it is necessary to unscrew the bulb to remove the holder.

In Fig. 11 I have represented the band or

collar *a* of the holder as flaring and as provided with an inwardly-projecting lip, *a'*, fitting around the body of a burner, and held and clamped in position by the pillar *C* of the burner.

Suitably modified, my invention may be embodied in holders for supporting various articles, such as cups or kettles, over lamp and gas burners for heating food, &c.

By my invention I produce a holder for shades, globes, &c., which, being made in one piece of metal, is very strong and durable, and which may be very cheaply manufactured.

I am aware that shade-holders have heretofore been made from a single piece of wire bent so as to form a band and arms and provided with a collar for the purpose of keeping the band in its cylindrical shape; but such holders had not an extensive bearing on the gas burner, as has mine, and hence were very unstable.

What I claim as my invention, and desire to secure by Letters Patent, is—

1. The shade-holder consisting of the collar *a* and longitudinally-corrugated arms *b*, bent outward therefrom and provided with hooks *d*, said collar, arms, and hooks being formed of a single piece of sheet metal, substantially as described.

2. The combination, with the shade-holder consisting of the collar *a* and arms *b*, formed in one piece, of the re-enforcing-ring *B*, surrounding said collar, substantially as described.

3. The combination, with the shade-holder consisting of the collar *a* and arms *b*, formed of a single piece of sheet metal, of the re-enforcing-rings *B*, fitting around said collar and provided with the lugs *c*, standing between the arms and bent over the edge of the collar, substantially as described.

H. DWIGHT STANLEY.

Witnesses:

MORRIS A. TYNG,

EDWARD P. JESSUP.