

(No Model.)

2 Sheets—Sheet 1.

S. A. MARKER.
BRIDLE OR HALTER.

No. 264,178.

Patented Sept. 12, 1882.

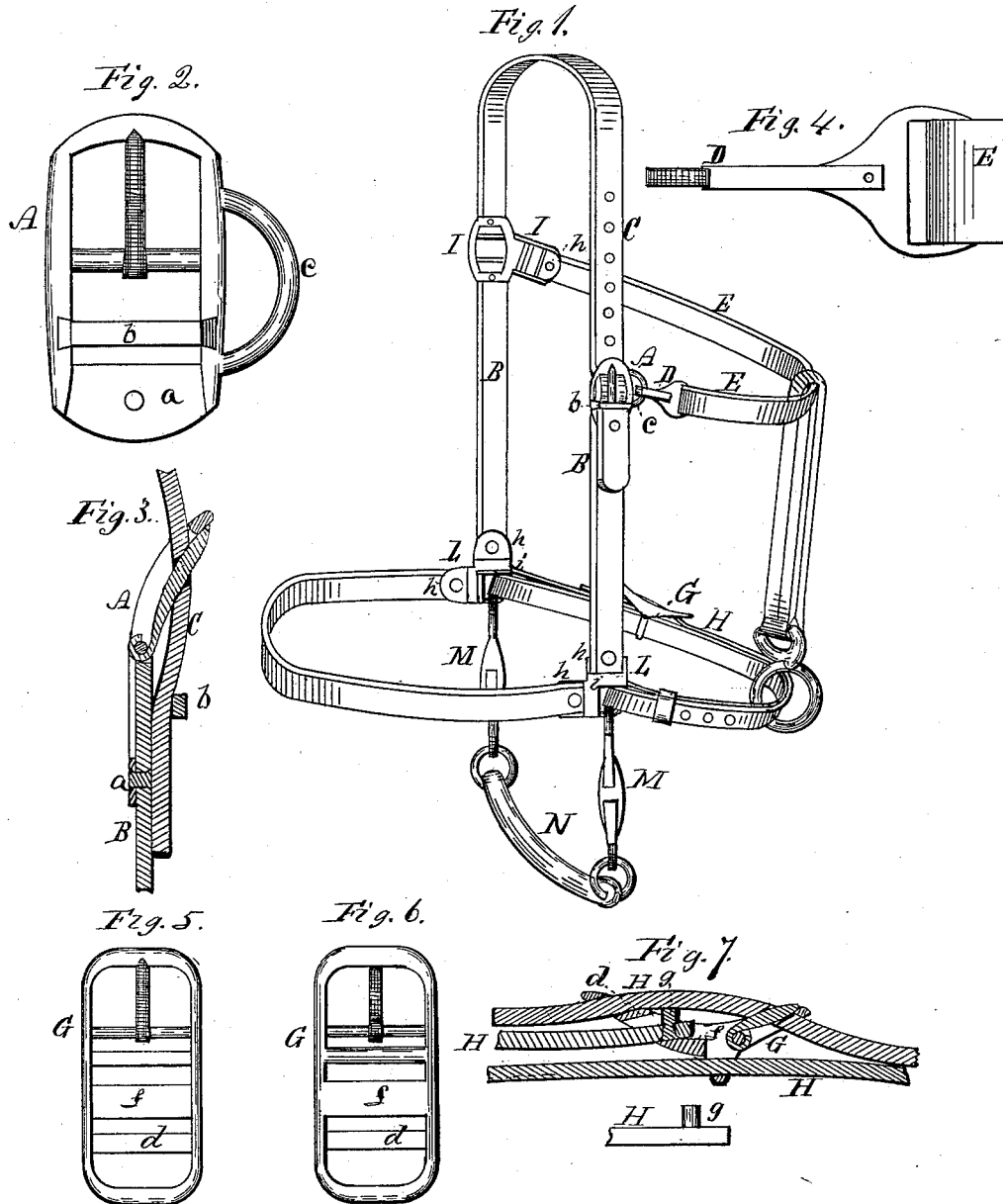

WITNESSES.

J. C. Day
James M. Wright.

INVENTOR -

Stephen A. Marker,
By his attorney,
J. S. Brown.

(No Model.)

2 Sheets—Sheet 2.

S. A. MARKER.
BRIDLE OR HALTER.

No. 264,178.

Patented Sept. 12, 1882.

Fig. 8.

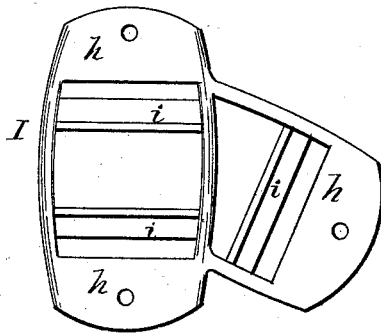

Fig. 9.

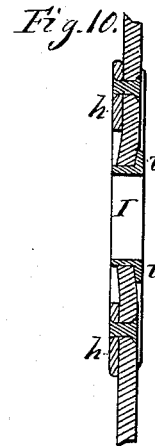
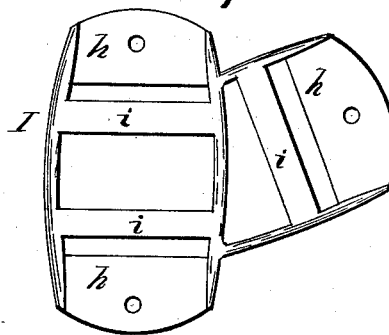

Fig. 11.

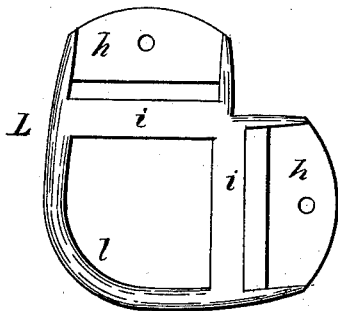

Fig. 12.

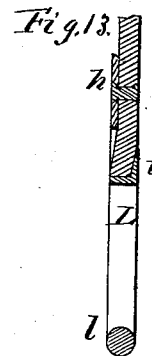
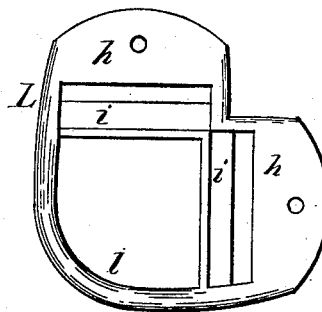

Fig. 14.



Fig. 15.

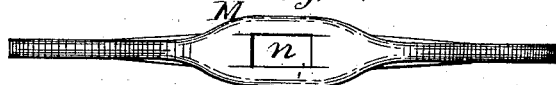
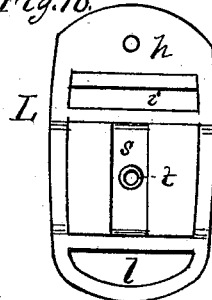

Fig. 16.



WITNESSES.

J. C. Day
James H. Wright.

INVENTOR.

Stephen A. Marker,
By his attorney,
J. S. Brown.

UNITED STATES PATENT OFFICE.

STEPHEN A. MARKER, OF NEWARK, NEW JERSEY.

BRIDLE AND HALTER.

SPECIFICATION forming part of Letters Patent No. 264,178, dated September 12, 1882.

Application filed July 29, 1882. (No model.)

To all whom it may concern:

Be it known that I, STEPHEN A. MARKER, of Newark, in the county of Essex and State of New Jersey, have invented Improvements in Convertible Bridle and Halter Mountings; and I do hereby declare that the following is a full and exact description thereof, reference being had to the accompanying drawings, making part of this specification—

Figure 1 being a view in perspective of a convertible bridle and halter represented as a bridle, and provided with my improved mountings; Fig. 2, a view of the buckle for buckling the crown-piece to one of the cheek-straps, and provided with a loop to receive a snap-hook on the throat-latch; Fig. 3, a section through the buckle and connected straps; Fig. 4, a view of the throat-latch snap-hook; Figs. 5 and 6, respectively, views of opposite sides of the chin-strap buckle; Fig. 7, a section of the said buckle with the adjacent parts of the connected straps; Figs. 8 and 9, respectively, views of opposite sides of the clip which permanently connects the crown-piece and one of the cheek-straps; Fig. 10, a section of the same with the connected straps; Figs. 11 and 12, respectively, views of opposite sides of the ring-clip, which connects the cheek-straps, nose-band, and chin-strap, and from which the snap-hooks are suspended for attaching the bridle-bit; Fig. 13, a section of the same and the end of the cheek-strap united thereto; Figs. 14 and 15, respectively, views of opposite sides of one of the double snap-hooks on which the bridle-bit is suspended; Fig. 16, a modified construction of the clip shown in Figs. 11, 12, and 13.

Like letters designate corresponding parts in all the figures.

The crown-buckle A, Figs. 2 and 3, has a sunk plate, *a*, to which the cheek-strap B is riveted or sewed, and by which its end is held between the side bars and back of the tongue-bar. The buckle also has a raised cross-bar, *b*, under which the crown-piece C is tucked. It has also a loop, *c*, projecting laterally from one side, into which the snap-hook D of the throat-latch E, Fig. 4, takes to secure the head-stall on the horse.

The chin-strap buckle G, Figs. 5, 6, and 7, has two special cross-bars, *d f*, between which

the fixed end of the chin-strap H fits, and this end of the strap has a rivet or permanently-attached boss, *g*, (shown separately below Fig. 7,) or any equivalent projection or enlargement, which serves as a catch to prevent the disengagement of the end of the strap from the buckle, since this rivet or boss (of any suitable construction) cannot be drawn out between the bars *d f* of the buckle. Thus all stitching, riveting, or other ordinary means of attachment are dispensed with. This is a very simple and cheap mode of construction, and is effectual for its purpose.

The clip or coupling plate I, Figs. 8, 9, and 10, is provided at the several strap-connections with flange-plates *h h*, to which the respective straps are riveted or otherwise secured. It also has angle-bars *i i* near the middle of the clip, into which the ends of the respective straps fit, as shown, whereby the said strap ends are shielded and screened. Thus a neat coupling is made, and one not liable to injury from violence.

The ring clip or coupling L, Figs. 11, 12, and 13, has similar flange-plates, *h h*, and angle-bars *i i*, whereby the straps are attached in the same way as with the clip I. This clip has also a corner or ring loop, *l*, in which are hooked or hung the snap-hooks M M, which also hook into the cheek-rings *m m* of the bit N, Fig. 1, when the halter is to be converted into a bridle.

Fig. 16 shows a modification of the clip or coupling L, adapted to receive a chin-strap and nose-band in one piece. The strap passes through the clip, over a bar, *s*, and is held by a tongue, *t*, on the said bar and entering a hole of the strap. The other parts of the clip are substantially as in the other figures, except as to form, which, as seen, is modified to suit the purpose.

The snap-hooks M M are double, or have hooks at both ends, as represented. Figs. 14 and 15, respectively, are views of opposite sides of my improved construction of this double snap-hook. A single spring, *n*, serves to close the hooks at both ends. An aperture, *p*, Fig. 15, is cast or formed in the middle of the body of the snap-hook, and a cross-bar, *r*, Fig. 14, divides this aperture into two parts. The spring is passed through the double ap-

erture thus formed under the cross-bar, as indicated. It is thus held securely in position without a rivet or any other separate attaching device, unless preferred.

5 What I claim as my invention, and desire to secure by Letters Patent, is—

1. As an improvement in bridles and halters, the crown-buckle A, constructed with the sunk plate *a*, raised cross-bar *b*, and side loop, *c*, in
10 combination with the cheek-strap B, crown-piece C, and throat-latch E, substantially as and for the purpose herein specified.

2. The chin-strap buckle G, constructed with the cross-bars *d f*, in combination with the
15 chin-strap H, provided with the rivet *g*, or its equivalent, substantially as and for the purpose herein specified.

3. The clips or couplings I L, constructed with the attaching-plates *h h* and angle shield-bars *i i*, in combination with the cheek-strap 20 B, crown-piece C, and throat-latch E, substantially as and for the purpose herein specified.

4. The double snap-hooks M M, constructed with the double aperture *p* and cross-bar *r*, for attaching the single spring *n*, in combination 25 with the coupling L and bit N, substantially as and for the purpose herein specified.

STEPHEN A. MARKER.

Witnesses:

HERMAN LEHLBACH,

R. J. D. DUNN.