

(No Model.)

2 Sheets—Sheet 1.

M. J. COLE.

TRUNK.

No. 348,188.

Patented Aug. 31, 1886.

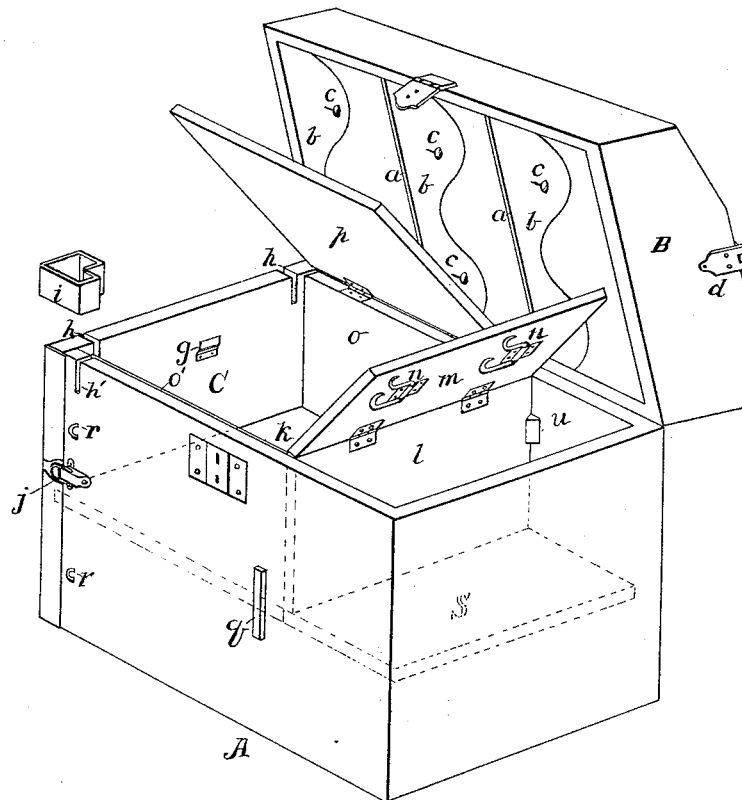

Fig. 1.

Witnesses  
Wm. A. Chapman  
Adolf Morrison

Inventor  
Mary J. Cole  
By her Attorney  
Eugene A. Perkins

M. J. COLE.

TRUNK.

No. 348,188.

Patented Aug. 31, 1886.

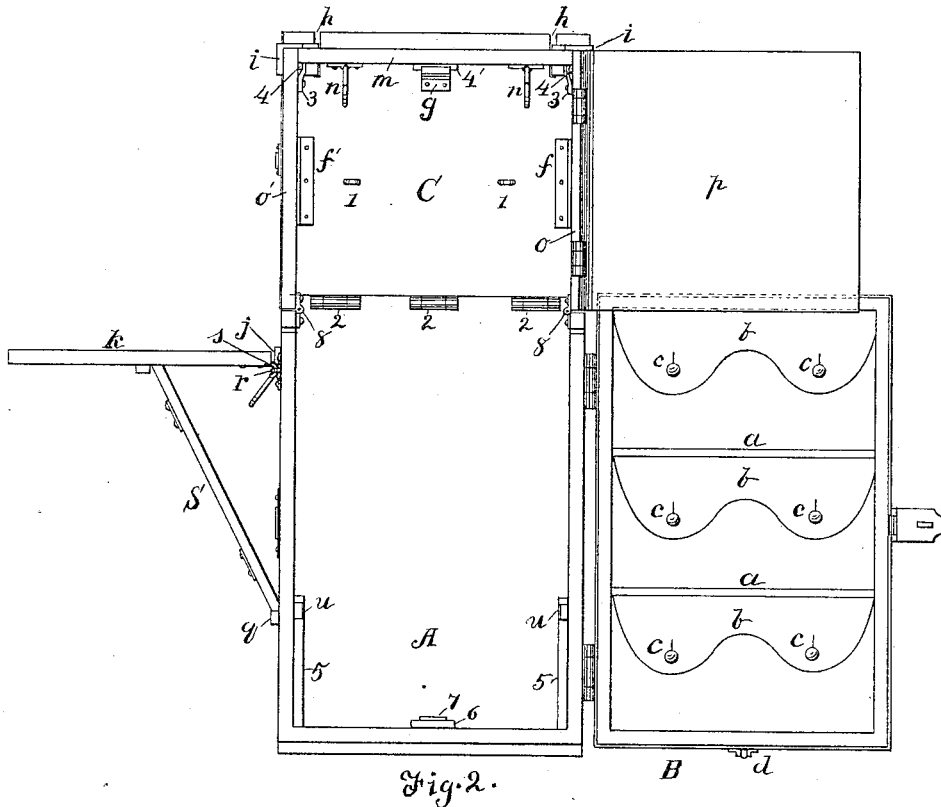

Witnesses  
Wm. A. Chapman  
Adolph B. Mason

Inventor  
May J. Cole  
By her Attorney  
Cyrus C. Perkins

# UNITED STATES PATENT OFFICE.

MARY J. COLE, OF GRAND RAPIDS, MICHIGAN.

## TRUNK.

SPECIFICATION forming part of Letters Patent No. 348,188, dated August 31, 1886.

Application filed February 27, 1886. Serial No. 193,534. (No model.)

*To all whom it may concern:*

Be it known that I, MARY J. COLE, a citizen of the United States, residing at Grand Rapids, in the county of Kent and State of Michigan, have invented certain new and useful Improvements in Trunks, being a combination of trunk and wardrobe; and I do declare the following to be a full, clear, and exact description of the invention, such as will enable others skilled in the art to which it appertains to make and use the same, reference being had to the accompanying drawings, and to the letters and figures of reference marked thereon, which form a part of this specification.

Figure 1 is a perspective view of my invention, showing trunk with lid raised. Fig. 2 is a front view showing trunk when opened up as wardrobe, with doors open and projecting table on side.

Similar letters refer to similar parts throughout both views.

My invention relates to trunks; and it consists in the improved construction and combinations of parts hereinafter fully described, and pointed out in the claims.

I describe my invention as follows:

The body of the trunk is shown at A, having the top B. The end C is hung at the bottom on hinges 2 2 2, and may be opened out. It is held, when shut up, by the locking-clasp *j* on the sides and the corner clips, *i*, at the upper corners slipping into the slots *h h'*. The side and top *l m* of the hat-tray are hinged together and removable from the trunk, as is also the bottom S of said tray. The bottom K of the main tray is also removable, and is provided with the hooks *s s*, which serve a double purpose—viz., holding it in position by engaging the staples 1 1 as a bottom to tray, and the staples *r r* when transferred to the outside of trunk, where it is converted into a table, the bottom S of hat-box being used as a brace to hold it in position, *q q* being stops for said brace.

Folding within the trunk is a false front and back piece, O O', hung on the hinges 8 8, and having the latches 3 3 on inside.

When it is desired to convert the trunk into

a wardrobe, it is turned up on the end opposite C, and the lid B swung back, rolling on the caster *d*, which is secured at or near the upper edge of the lid at one end thereof, the trunk-body being a little longer than the lid or cover, so that when the trunk is placed on end and arranged to be used as a wardrobe, the caster will be on a line with the said lower end, and the trunk will sit in a perfectly upright position. The parts forming the hat-box, hereinbefore described, are removed and then the bottom *k* of the main tray. The end C is then put up to a perpendicular position, and the side pieces, *o o'*, are then raised, the top *p* of tray thus becoming an upper door to the wardrobe, of which the parts *l m* become the top.

*ff* are stops to prevent the falling over of side pieces, *o o'*, and also serve as inside stays of trunk when closed.

3 and 4 are catches to keep parts in position, as also is *g*.

*n n* are hooks for top of wardrobe, which may be of any number, turning down flat when not in use, as shown in Fig. 1.

5, 6, and 7 are supports, and *u* is a stop for side of hat-box.

The top of the trunk may be divided into pockets, as shown at *c c c*, having the partitions *a a* and the fastenings C.

I claim and desire to secure by Letters Patent of the United States—

1. In a trunk, the removable parts K and S, forming the bottom of tray and hat-box, and adapted to be removed and attached to outside of trunk, forming a writing-desk, as shown and described.

2. In a trunk, the hinged end C, the inlaping side pieces, *o o'*, parts *l* and *m*, and the cover *p*, adapted to be opened up, so as to form a wardrobe, as shown and described.

3. In a trunk, a hinged end, C, adapted to open out and provided with the slots *h h'*, and the corner clasps, *i i*, as shown and described.

4. In a combined trunk and wardrobe, in combination with the permanently-closed end and cover or lid, of a caster arranged upon the end of the cover or lid, all substantially as described.

5. The combination, with a trunk having one of its ends hinged to the bottom corner clips, *i*, for securing its upper end to the sides, and the snap-locks secured to the sides of the trunk and adapted to engage said hinged end, substantially as set forth.
6. The combination, with a trunk, of the bottoms *k* S, the vertical partition, the lid hinged to the upper end of the same, and the hinged lid *p*, substantially as set forth.
- In testimony whereof I affix my signature in presence of two witnesses.
- MARY J. COLE.
- Witnesses:  
WM. A. CHAPMAN,  
ADOLPH B. MASON.