

(No Model.)

R. HORTON.
LAND ROLLER AND STALK CUTTER.

No. 348,284.

Patented Aug. 31, 1886.

Fig. 1.

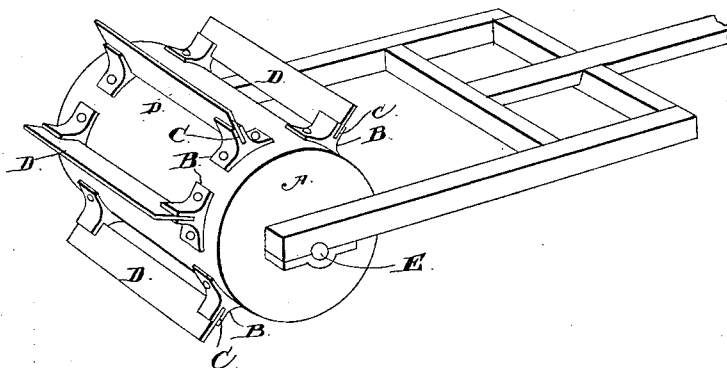

Fig. 2.

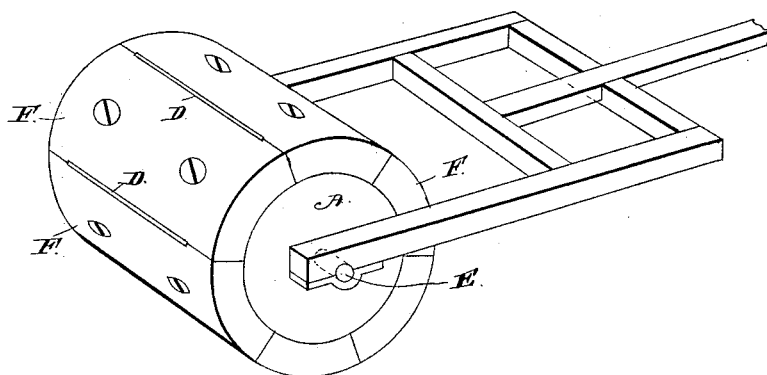
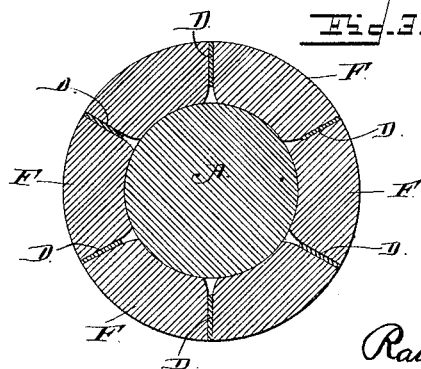

Fig. 3.



Witnesses
M. E. Fowler
J. W. Garner

Inventor
Raughley Horton

By *his* Attorneys

C. A. Snowden

UNITED STATES PATENT OFFICE.

RAUGHLEY HORTON, OF WALTON, KANSAS.

LAND-ROLLER AND STALK-CUTTER.

SPECIFICATION forming part of Letters Patent No. 348,284, dated August 31, 1886.

Application filed June 10, 1886. Serial No. 204,764. (No model.)

To all whom it may concern:

Be it known that I, RAUGHLEY HORTON, a citizen of the United States, residing at Walton, in the county of Harvey and State of Kansas, have invented a new and useful Improvement in Land-Rollers and Stalk-Cutters, of which the following is a specification.

My invention relates to an improvement in land-rollers and stalk-cutters; and it consists in the peculiar construction and combination of devices that will be more fully set forth hereinafter, and particularly pointed out in the claim.

In the drawings, Figure 1 is a perspective view of my invention when used as a stalk-cutter. Fig. 2 is a similar view of the same when used as a land-roller. Fig. 3 is a transverse sectional view of the same.

A represents a cylindrical core, which may be made of wood or any other preferred material, and is provided on its face or periphery, near its ends, with a number of outwardly-extending brackets or arms, B. In the outer ends of these brackets or arms are made slots C, and in the said slots are fitted and secured the ends of longitudinal blades D, which extend lengthwise on the core, and are secured equidistant from each other. The said cutters or blades D are comparatively narrow, and the slots C, which are made in the outer ends of the bracket-arms, do not extend inwardly as far as the face of the core, thus supporting the inner edges of the blades at a distance from the face of the core, and thereby forming spaces between the inner edges of the blades and the core, as shown. Trunnions E project from the ends of the core at the center thereof, and

thus adapt the device to be journaled in a suitable frame. When the machine is drawn along the ground, the sharpened edges of the blades D enter the ground and cut the corn-stalks lying on the ground into short pieces, thus enabling them to be readily turned under and cleared out of the way.

In order to adapt the invention for use as a land-roller, I provide a series of segmental sections, F, which correspond in length to the core, and are adapted to fit between the blades on the face of the core, so as to form a bearing-face for the roller. These sections are here shown as secured in position on the core and between the blades by means of ropes or screws, but they may be secured thereto in any other preferred manner, if desired.

From the foregoing it will be readily understood that the invention is adapted for use either as a stalk-cutter or land-roller, thus furnishing a machine which is cheap and simple in construction and of great practical utility.

Having thus described my invention, I claim—

In a roller and stalk-cutter, the combination of the cylindrical core having the radial blades and the segmental sections removably secured to the core between the blades, substantially as described.

In testimony that I claim the foregoing as my own I have hereto affixed my signature in presence of two witnesses.

RAUGHLEY HORTON.

Witnesses:

C. F. WALDER,
JAS. MCARTHUR.