

(No Model.)

2 Sheets—Sheet 1.

T. I. LUDWIG.

CORN HUSKER.

No. 348,528.

Patented Aug. 31, 1886.

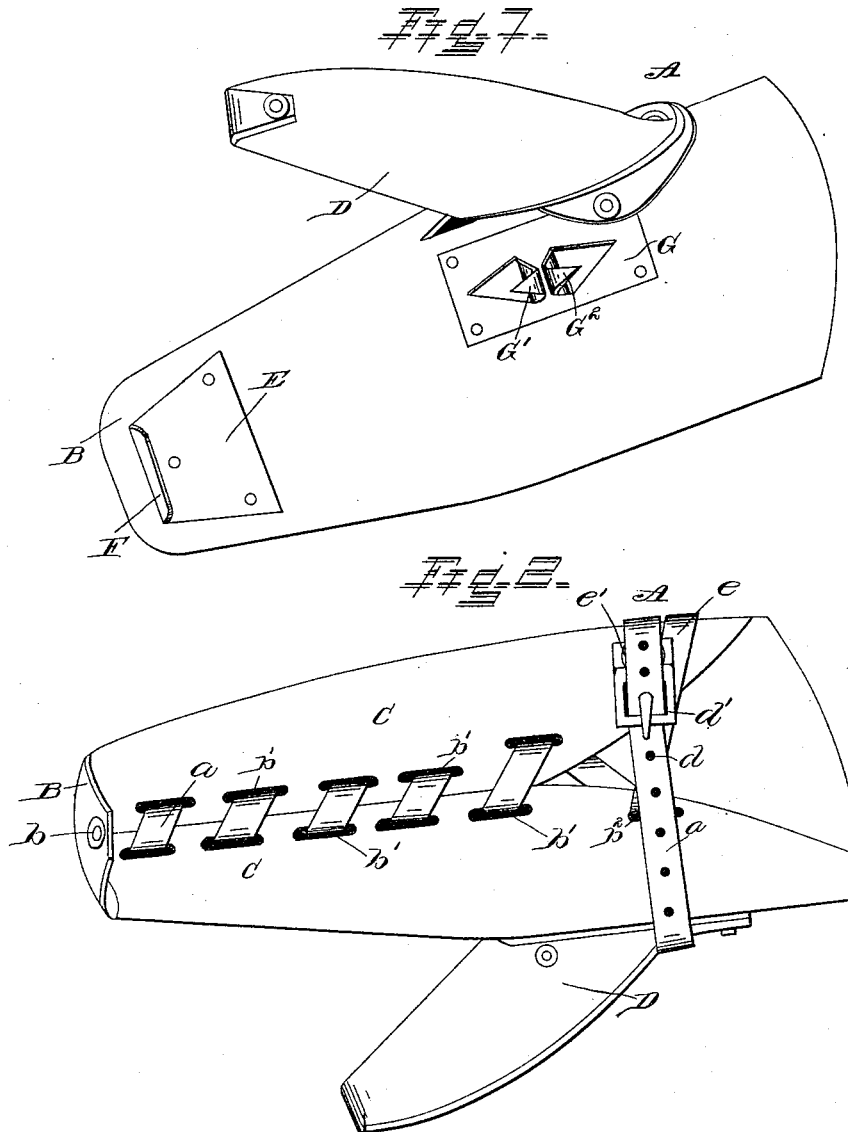

WITNESSES.

Howard J. Schneider
John M. Carr.

INVENTOR.

Thomas I. Ludwig
By Myer & Co.

ATTORNEYS

(No Model.)

2 Sheets—Sheet 2.

T. I. LUDWIG.

CORN HUSKER.

No. 348,528.

Patented Aug. 31, 1886.

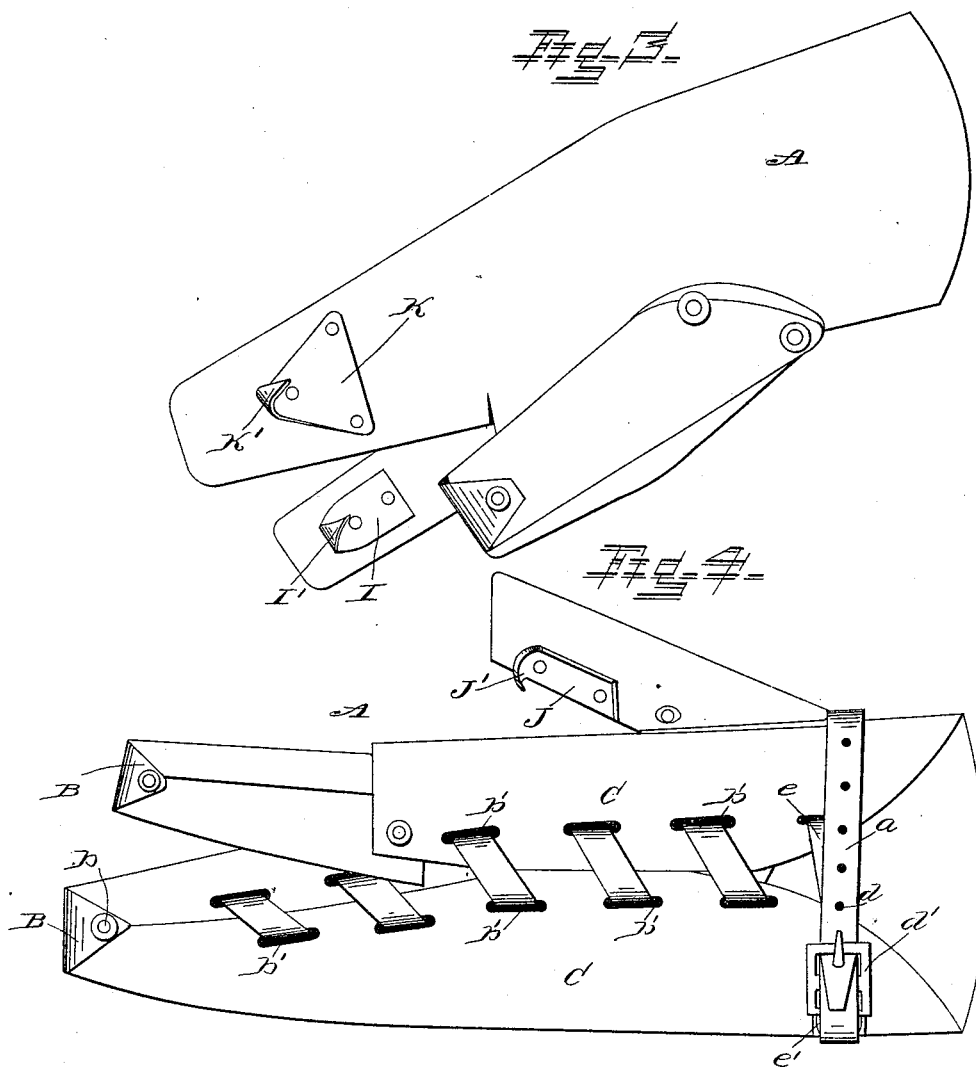

WITNESSES.

Howard J. Schneider
John M. Lee

INVENTOR.

Thomas I. Ludwig
By Myself

ATTORNEYS

UNITED STATES PATENT OFFICE.

THOMAS I. LUDWIG, OF FREMONT, ASSIGNOR OF ONE-HALF TO GEORGE MOORE, OF BALLVILLE, OHIO.

CORN-HUSKER.

SPECIFICATION forming part of Letters Patent No. 348,528, dated August 31, 1886.

Application filed November 27, 1885. Serial No. 184,113. (No model.)

To all whom it may concern:

Be it known that I, THOMAS I. LUDWIG, a citizen of the United States of America, residing at Fremont, in the county of Sandusky and State of Ohio, have invented certain new and useful Improvements in Corn-Huskers, of which the following is a specification, reference being had therein to the accompanying drawings.

My invention relates to an improvement in mitten corn-huskers, one for each hand; and it consists in mittens adapted to be fitted to hands of dissimilar size and there secured, the mittens having riveted thereto metallic plates having tangs and lips for husking corn, substantially as hereinafter more fully set forth, and particularly pointed out in the claims.

In the accompanying drawings, Figure 1 is a perspective view showing the inside of the right hand of the mitten corn-husker. Fig. 2 is a plan view of the outside of the hand thereof. Fig. 3 is a view in perspective showing the inside of the holding or securing mitten. Fig. 4 is a plan view showing the outside thereof.

In constructing my mitten corn-husker the finger end of both the right and left hand mittens A is formed by turning over toward the outside of the hand the lapel B, and riveting the same to the abutting edges C, constituting the outside of the hand or body of the glove, and to the end of lacer *a*. The lacer *a* in each mitten consists of a narrow strip of leather or other suitable material secured at one end by the rivet *b*, from whence it is laced in corresponding slits, *b'*, formed at intervals in the abutting edges constituting the outside of the hand or body of the mitten. The lacer *a*, after the mitten is suitably laced to suit the size of the wearer's hand, is passed from in under up through the slit *b'*, and thence slightly to one side of the buckle *d'*, and is then carried around the wrist and then buckled to the said buckle *d'*, the lacer *a* being provided with apertures *d* for this purpose. Buckle *d'* is secured to the mitten by means of the folded strap *e* and rivet *e'*.

Thumb D is formed by cutting out and folding a strip of leather or other suitable material into the shape of a thumb. The outer end of the thumb thus formed is closed by

folding it over toward the inside of the hand and riveting it, as shown. In fitting the mitten-thumb to the mitten, a coincident slit is formed in the body of the mitten for passage of thumb, and the mitten-thumb D is arranged in line with said slit and there riveted.

The above-described mitten, which is for use on the right hand of the operator, has on the inner side of the hand thereof and riveted thereto the triangular metallic plate E, turned up at the side nearest the ends of the fingers to form the sharpened lip F. The said mitten has also riveted on the inner side thereof, near the base of the thumb, tang-plate G, which has formed therein two corresponding tangs, G' and G'', pointing in opposite directions, the end of each tang being cut out from the tang-plate, projected back from the aperture thus formed in the plate, and then curved over toward it.

The holding or securing mitten, (shown in Figs. 3 and 4,) which is for use on the left hand of the operator, is made similar to its right-hand mate, excepting that a glove index-finger, made in the same manner as the thumb of the right-hand mitten, is riveted thereto, the mitten being narrowed to a point corresponding to the base of the index-finger, for reception of said finger, as shown. The index-finger of the left-hand mitten has riveted thereto the tang-plate I, its tang I' being curved and projected toward the wrist, and a corresponding tang-plate, J, is riveted to the inside of the mitten-thumb, its tang J' being curved toward the base of the thumb. The holding or securing mitten has also riveted thereto on its inside, at a point corresponding to the position of the fingers when gloved, a triangular tang-plate, K, having a tang, K', curved toward the wrist. These tangs thus arranged greatly facilitate the corn-husking operation, in connection with the right-hand mitten, which is also being simultaneously used in the operation.

Thus constructed and arranged, the operation of corn-husking is not only more expeditiously and with greater facility performed, but the hands of the operator are fully protected.

I do not confine myself to the use of leather for the construction of any part of the mit-

tens, as it is obvious that cloth and many other materials may also be employed with results alike beneficial; nor do I confine myself to the use of rivets, as the parts may be sewed or secured together by ordinary means.

5 Having thus fully described my invention, what I claim as new, and desire to secure by Letters Patent, is—

1. A mitten corn-husker comprising a body
10 having longitudinal abutting edges, provided with slits at suitable intervals, and a lacer secured at one end by a rivet and at the other by a buckle attached to one of said edges, substantially as shown and described.

2. In a mitten corn-husker, the combination 15 of the body having longitudinal abutting edges with suitable slits, the lacer *a*, plate E, having lip F, and tang-plate G, provided with oppositely-projecting tangs *G'* *G''*, substantially as shown, and for the purpose specified. 20

In testimony whereof I affix my signature in presence of two witnesses.

THOMAS I. LUDWIG.

Witnesses:

B. R. DUDROW,
J. R. CONKLIN.