

(No Model.)

H. A. MATTOX & E. EVANS.
 PLOW.

No. 421,506.

Patented Feb. 18, 1890.

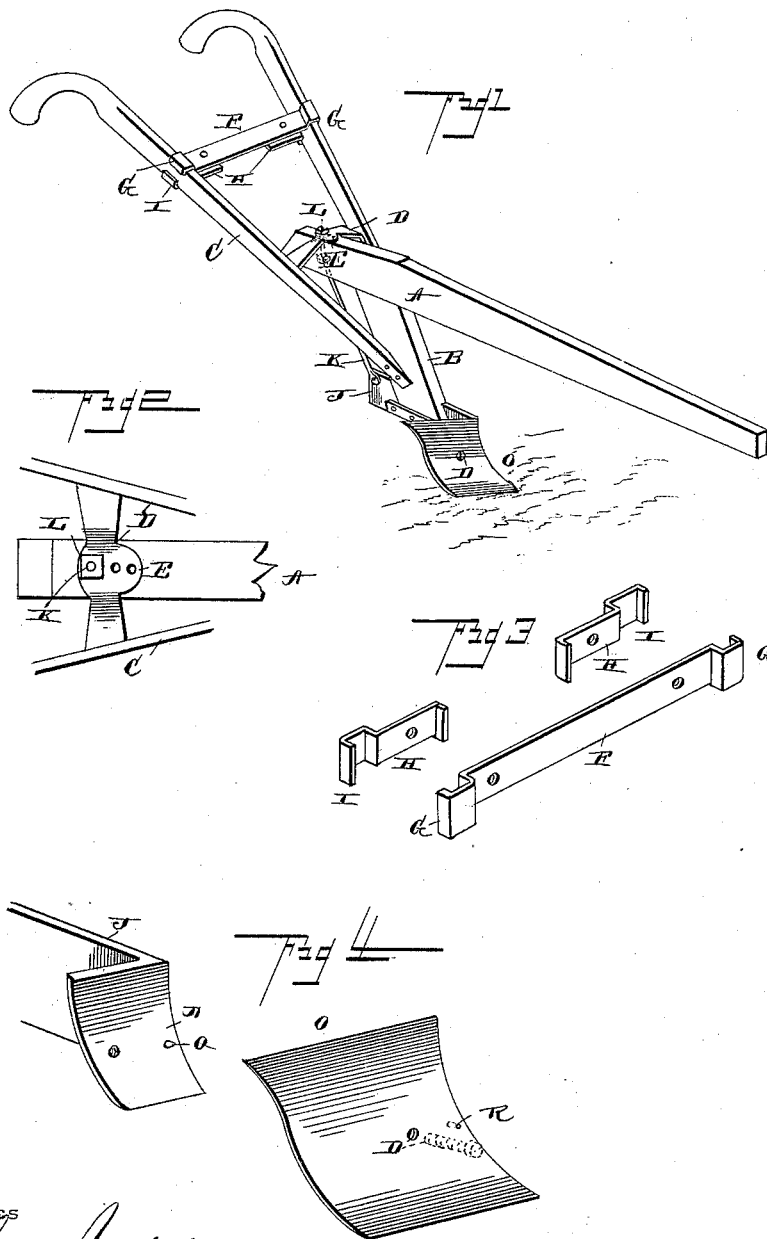

Witnesses

Witnesses
John Amirie
E. L. Siggers

Invention

By their Attorneys,
Hamilton T. Mattox
Elijah Evans
C. A. Snow & Co.

UNITED STATES PATENT OFFICE.

HAMILTON A. MATTOX AND ELIJAH EVANS, OF HOMERVILLE, GEORGIA.

PLOW.

SPECIFICATION forming part of Letters Patent No. 421,506, dated February 18, 1890.

Application filed August 28, 1889. Serial No. 322,203. (No model.)

To all whom it may concern:

Be it known that we, HAMILTON A. MATTOX and ELIJAH EVANS, citizens of the United States, residing at Homerville, in the county of Clinch and State of Georgia, have invented a new and useful Plow, of which the following is a specification.

Our invention relates to improvements in plows; and it consists in certain novel features of construction hereinafter described and claimed.

In the accompanying drawings, Figure 1 is a perspective view of our improved plow. Fig. 2 is a detail plan view. Fig. 3 is a detail view of the clamp for the handles. Fig. 4 is a detail perspective view of the plowshare.

The plow beam or tongue A, the standard B, and the handles C are of the usual or any preferred construction and are arranged in the ordinary manner. The handles are secured to the standard and project upward and rearward therefrom, and are connected by a cross-bar or brace D, which is provided at its center with a series of openings E, through any one of which the securing-bolt may pass, so that by passing the said bolt through the proper opening the handles will be moved forward or backward, and consequently set higher or lower, so as to be adjusted to the height of the operator. Near the upper ends of the handles we provide the cross-bar F, which is provided at its ends with the L-shaped portion or hooks G, which are fitted over and around the front edges of the handles, and to the said cross-bar, near the end of the same, we secure the clamping-plates H, the ends of which are provided with the L-shaped portions or hooks I, which are adapted to pass around the lower or rear edges of the handles, so that the handles will be effectually braced and secured together. This arrangement provides for the easy removal of the handles when it is desired to store the plow in a small space, or when it is desired to repair a broken handle, as will be readily understood.

The landside J is secured to the lower end of the standard, and a brace K has its lower end secured to the rear end of the landside and extends upward therefrom to the rear end of the beam or tongue, and then vertically upward through the said beam or tongue. The upper end of this brace K is threaded, and a

nut M is mounted on the said threaded portion and adapted to bind against the under side of the beam or tongue. The extremity of the brace passes through one of the openings E in the cross-bar D, and the nut L is mounted thereon and adapted to be turned down against the said cross-bar, so that the brace will be firmly secured and the cross-bar fastened in place.

At the front end of the landside we provide the offset N, and the plowshare O is secured to the said offset by a single central bolt D. The plowshare is substantially diamond-shaped, its upper and lower edges being both straight and sharpened, so that the plowshare can be readily reversed when one edge is worn, so as to bring the other edge into operative position, and thus prolong the durability of the plow. The share is prevented from rotating while in use by means of a stud Q on the offset N, which engages a perforation R in the plowshare near the edge of the same, as clearly shown.

In practice the plow is drawn over the field in the usual manner and turns up the dirt, as will be readily understood. When one edge of the share has been worn, the central securing-bolt is loosened and the plowshare is then rotated, so as to bring the other edge into the lower position. The securing-bolt is then tightened and the plow operated as before.

It will be readily observed that we have provided a plow which is very durable, and its advantages are thought to be obvious. The brace which secures the landside also secures the cross-bar D to the handles, so that great strength is imparted to the plow, and the landside is held rigidly to its work. The handles can be readily adjusted to the desired height, and if one of the handles should be broken it can be quickly removed and a new one substituted by simply removing or loosening the clamping-plate, as will be readily understood.

Having thus described our invention, what we claim, and desire to secure by Letters Patent, is—

1. In a plow, the combination of the beam, the standard, the landside secured to the standard, the handles secured to the standard and projecting upward therefrom, the cross-bar connecting the handles and provided with a series of perforations at its center, and the

brace secured to the landside and projecting upward through the beam and one of the perforations in the cross-bar, as set forth.

2. The combination of the handles, the cross-bar arranged between the same and engaging the edges thereof, and the clamping-plates secured to said cross-bar and engaging the handles, as set forth.

3. The combination of the handles, the cross-bar provided with L-shaped portions at its ends engaging the upper edges of the handles, and the clamping-plates secured to the cross-bar and provided with L-shaped portions at their ends engaging the under edges of the handles, as set forth.

4. The landside provided at its front end

with an integral lateral offset N, which is curved and shaped to conform to the rear side of the reversible share and provided with the stud or projection Q, in combination with the reversible plowshare O, provided near its edges with perforations R R, and the central securing-bolt, substantially as set forth.

In testimony that we claim the foregoing as our own we have hereto affixed our signatures in presence of two witnesses.

HAMILTON A. MATTOX.
ELIJAH EVANS.

Witnesses:

A. G. CASWELL,
N. C. SINGELTARY.